

# Arena B

31,860 sq ft (270x118) Dirt Floor  
Return Alley (238x40)

4,300 total seating (1800 perm, 2500 port)

Climate Controlled Lunchroom: seating 40

Roping Box  
Concessions  
Restrooms

Utilities: 120V Electrical

Sound Capability- Systems available from 500 to 50,000 watts  
2bl/Crown/Lexicom single to 56 channel Soundcraft Processing

Lighting Capability- Systems available from single fixture to 120K lightshow  
Leprecaun/Tomcat/ETC Source 4/Altman

Ventilation System located:  
Closet in Kitchen for Office and Café Area

Sprinkler System located:  
NW corner/Aound room

Fire Extinguisher Located:  
#3 on pole on West Side

Alleyway to Barn 5

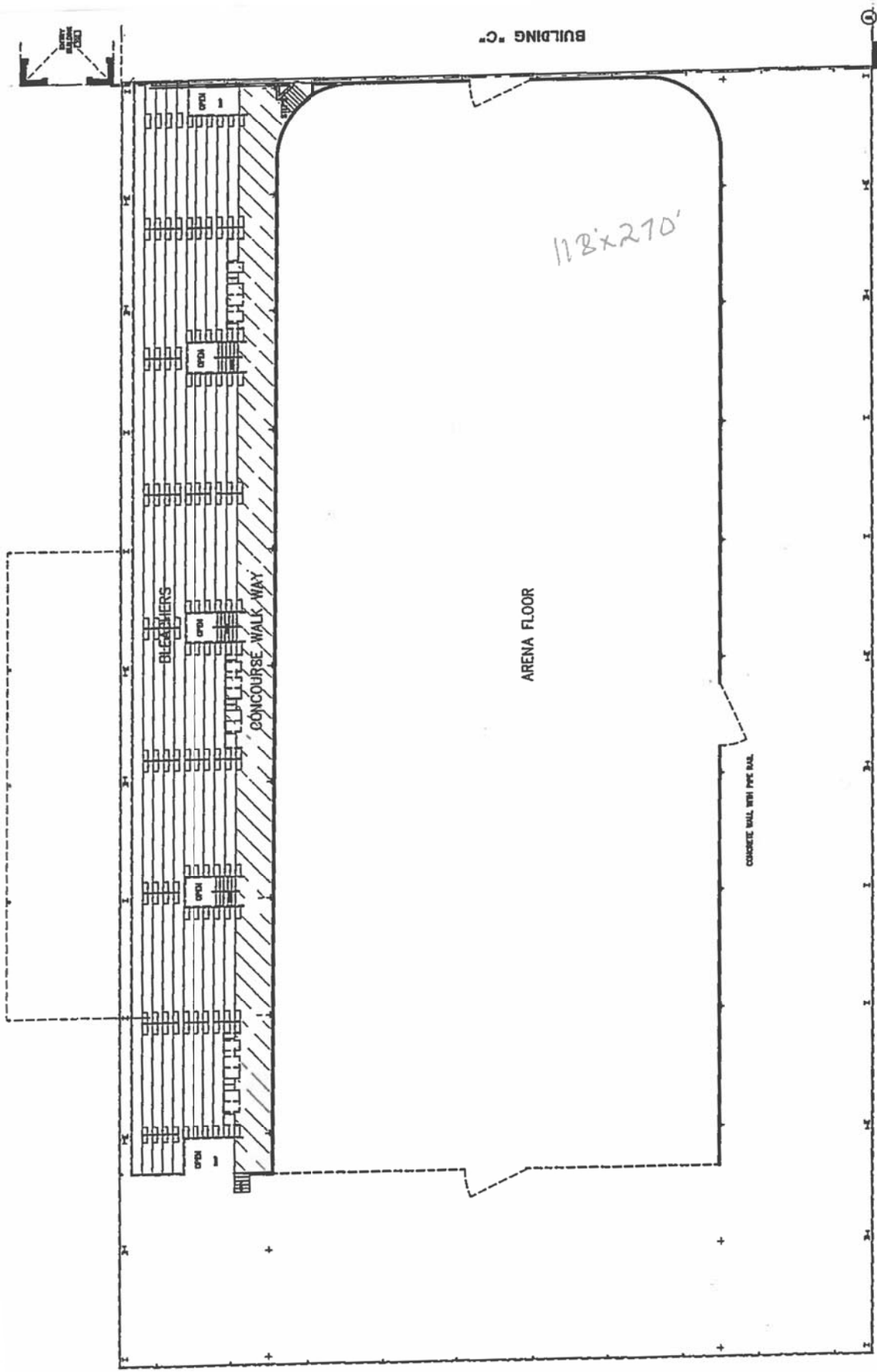

**1** BLEACHER LEVEL "B"  
FLOOR PLAN  
1/8"=1'-0"